

Impinger/Bubblers

For collecting various airborne gases, vapors and particulates using a high flow sampling pump

Gilian Impingers are special glass tubes designed to collect airborne contaminants by bubbling the sampled air at a high flow rate through a method-specific absorbing liquid inside. The impinger liquid used can be analyzed to determine airborne contaminant levels. Impingers can be mounted directly to a personal air sampling pump or a special spill-proof version can be attached to the worker's collar with a clip.

Midget Impingers, 25 ml - Standard, "Bubbler" and Special

These two-piece glass impingers have a capacity of 25 ml and a graduated scale along the side in 5 ml increments. The tip is precisely spaced in relation to the bottom of the impinger.

- The Standard Midget Impinger has its two glass pieces joined by a 24/40 ground joint.
- The "Bubbler" or Fritted Midget Impinger is like the standard impinger, except it has a special fritted tip to increase the interaction between the air sample and the impinger liquid by breaking the air stream into smaller bubbles and thereby increasing surface area.
- The Special Midget Impinger has a Teflon® sleeve on the glass stopper, allowing its use for ozone sampling.



Micro Spill-Proof Midget Impinger

This impinger is designed with traps to keep the liquid from spilling out, should they be tipped accidentally. It comes with a collar clip, allowing placement within the worker's immediate breathing zone. Very light in weight, the micro spill-proof impinger has a capacity of 2 oz (50 ml) and is made of PVC coated glass.

Moisture Traps & Holders

Moisture traps are designed to prevent moisture carryover from the impinger that might internally damage the sampling pump. Single and double holders are available for midget impingers and traps. A mounting bracket is also required when mounting these holders to Gilian 5000, Gilian 3500, GilAir-3, GilAir-5, or BDX II pumps.



Micro Spill-Proof Midget Impinger

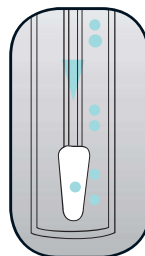

Bubbling action of fritted tip.



	Size	Description	Part No.
Impingers			
Standard Midget	25ml	2-pc., glass, 5ml increments	400165
Fritted Plastic	2oz	Fritted, 2-pc, plastic	800776
Fritted Midget (Bubbler)	25ml	Fritted, 2-pc., glass, 5ml increments	400506
Special Midget, Teflon	25ml	2-pc., glass, Teflon sleeve, Ozone, 5 ml increments	400509
Spill-proof, Micro, 2 oz.	50 ml	PVC-coated glass, fritted, collar clip	800772
Moisture Traps			
Standard Moisture Trap	98 ml	Plastic w/ 36"(91 cm) length of 1/4"(6.4 mm) ID tubing	800217
Midget Sorbent Trap	25 ml	Glass w/ screw cap	200241
Holders			
GilAir Plus Impinger Kit, Single	—	Aluminum holder with mounting bracket for GilAir Plus pump	811-0921-01-R
GilAir Plus Impinger Kit, Double	—	Aluminum holder with mounting bracket for GilAir Plus pump	811-0921-02-R
Impinger Holder, single	—	Aluminum/black, GilAir-3/GilAir-5/Gilian 800i/5000/10i/12	200222
Impinger Holder, double	—	Aluminum/black, GilAir-3/GilAir-5/Gilian 800i/5000/10i/12	200131
Mounting Bracket for Impinger Holder	—	Required to mount impinger holder to GilAir-3, GilAir-5 and BDx II pumps	801146
Mounting Bracket for Impinger Holder	—	Required to mount impinger holder to Gilian 800i/5000/10i/12 pumps	801983

Gas Sampling Bags

For convenient sample collection of specific compounds

Sensidyne carries a full line of Kynar® and Teflon® Gas Bags, which are convenient for grab sampling or TWA sampling of ambient chemical hazards for which other, conventional sampling methods are not available. NIOSH requires the use of the bag sampling method for certain compounds.

Reusable Gilian Gas Bags feature a quality construction that offers both durability and flexibility, as well as very long service life. They are both fatigue and temperature resistant and have a large sample port for easy flushing.



Kynar Gas Sampling Bags		Teflon Gas Sampling Bags		
Capacity (liters)	Part No.	Nominal Capacity (liters)	Valve Type	Part No.
0.5	KB-05	0.5	On/Off Valve	TE-22
1.0	KB-1	1.2	On/Off Valve	TE-21
3.0	KB-3	4.7	On/Off Valve	TE-23
5.0	KB-5	5.0	On/Off Valve	TE-24
10.0	KB-10	0.5	Septum Valve	TE-25
25.0	KB-25	1.2	Septum Valve	TE-26
50.0	KB-50	4.7	Septum Valve	TE-27
100.0	KB-100	50.0	Septum Valve	TE-28
200.0	KB-200	—	—	—

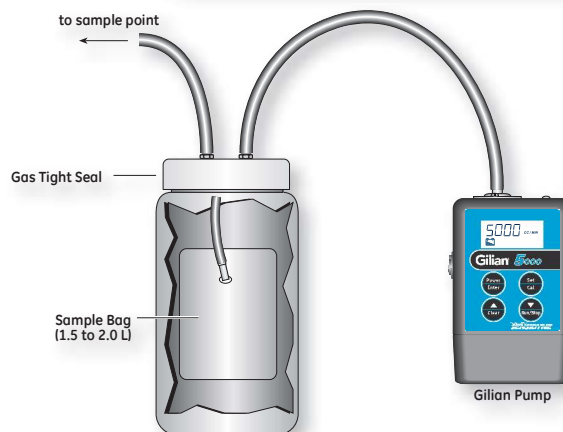

Vacuum Sampler with 1 gallon bottle.
(Bottle should be clear or "see-through")

811-9901-01